



BEAUTIFUL ART DECO LOOKING FOR LOVE

Graced with a lovely, elevated position just 200m to Leura Mall, this grand two-level Art Deco double brick beauty of stunning originality is ready to be both restored to its former glamour and brought into the modern day, all on 572m2 of land.

Through the curved glass formal entrance, you'll be immediately impressed by the beautiful foyer with its gorgeous timber staircase and the generous proportions of the formal living room. Also on the ground floor are multiple storage rooms, a

Upstairs on the main level, the spacious loun

Council Rates: \$547.00 p/q

Water Rates: \$175.00 p/q

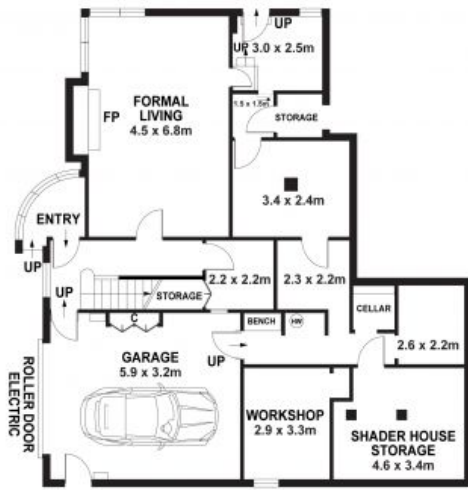

GROUND FLOOR



FIRST FLOOR

23 GREAT WESTERN HIGHWAY, LEURA

DISCLAIMER

PLANS SHOWN ARE FOR MARKETING PURPOSES ONLY. ALL DIMENSIONS ARE APPROXIMATE AND NOT TO SCALE. THEY ARE SUBJECT TO ERRORS AND INACCURACIES AND NO LIABILITY WILL BE ACCEPTED. INTERESTED PARTIES SHOULD MAKE THEIR OWN ENQUIRIES.