



## FABULOUS LEVEL LIVING IN COMFORT AND STYLE

Perfectly positioned behind charming established gardens on a fabulous, completely-level corner block of 784sqm, this beautiful single level steel frame brick home is ready for you to simply move in and enjoy. With an impressively wide frontage, a north-facing aspect, wonderful levels of privacy and a modern yet classic style, this home is sure to impress even the fussiest buyer.

Upon entry you will instantly feel at home with engineered hybrid flooring, abundant natural light and a gorgeous neutral colour palette which allows you to easily incorporate your own style. Perfect for families and those who like to entertain in comfort, the open plan lounge and dining room off the kitchen leads out to the verandah and backyard through glass doors, whilst also enjoying a sunny North

**Council Rates:** \$1,800.00/year (approx)

**Water Rates:** \$178.00 p/q

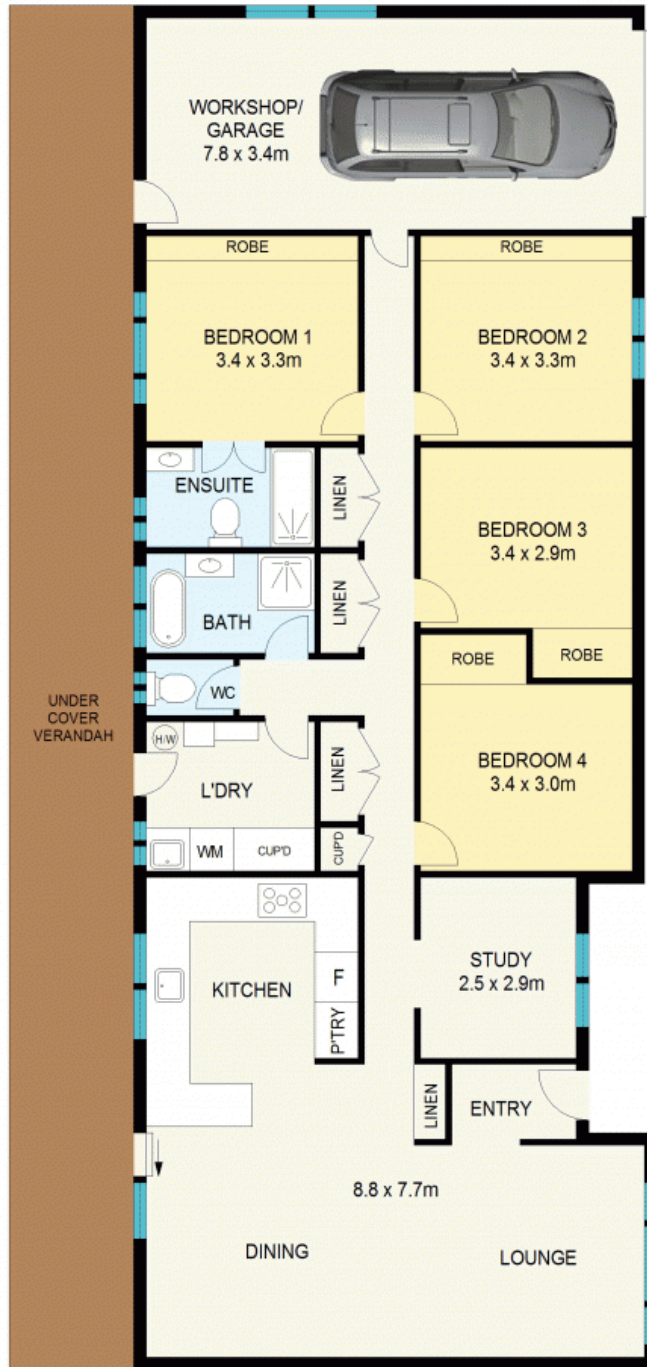
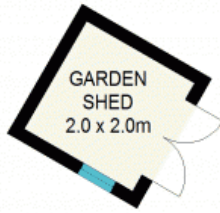

GROUND FLOOR

APPROX : GROSS INTERNAL AREA :- 164 SQM  
APPROX : GROSS EXTERNAL AREA :- 56 SQM



All information contained herein is gathered from sources we believe to be reliable.  
We cannot however guarantee its accuracy and interested parties should make and rely on their own enquiries



173 Tableland Road

Wentworth Falls

173 Tableland Road

Wentworth Falls, NSW