

14 Cox Avenue Wentworth Falls, NSW



3



2



2



## CHARMING SOUTHSIDE WEATHERBOARD

This charming weatherboard home is perfectly positioned on a 891 square meter established garden block in this highly sought after street only 600m to the village of Wentworth Falls and is even closer to the Grammar School.

A stunning example of old-world charm with French doors leading out from both the study and dining room onto the north facing wrap around veranda with the classic bullnose roof.

In the formal living room, you will enjoy the warmth brought to you by the built-in slow combustion fireplace set in a period styled ti

**Council Rates:** \$479.00 p/q

**Water Rates:** \$175.00 p/q



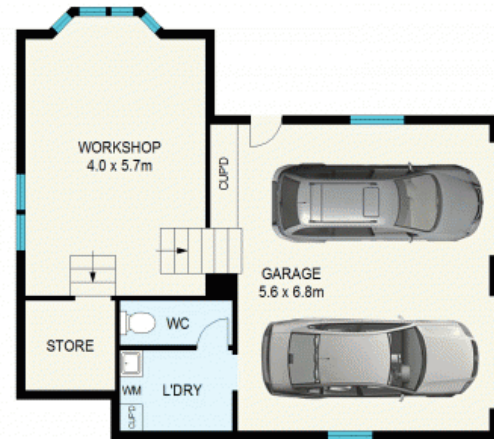

LOWER GROUND FLOOR



GROUND FLOOR

APPROX : GROSS INTERNAL AREA :- 206 SQM  
APPROX : GROSS EXTERNAL AREA :- 57 SQM

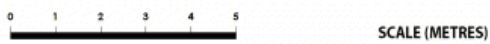

All information contained herein is gathered from sources we believe to be reliable.  
We cannot however guarantee its accuracy and interested parties should make and rely on their own enquiries



14 Cox Avenue

Wentworth Falls

14 Cox Avenue

Wentworth Falls, NSW

