

37-38/100-116 Leura Mall Leura, NSW



2



2



2



TWO SEPARATE FULLY FURNISHED UNITS

Weekly rental \$400pw each! Contemporary apartments in premium location. Superbly located in the Leura Village precinct, these dual key apartments offer tremendous appeal as a comfortable home or investment. Enjoying an elevated location, the excellent design capitalises on the green district views.

Light filled, and airy the open plan living areas flawlessly blends indoors with out through glass sliders connecting the lounge and dining with the spacious balconies. (Double Glazed)

Each apartment has a very spacious bedroom with built in robe and a private balcony to enjoy the superb setting. The large bathrooms ar

Council Rates: \$204.00 p/q
Water Rates: \$150.99 p/q
Strata Rates: \$1,791.35 p/q

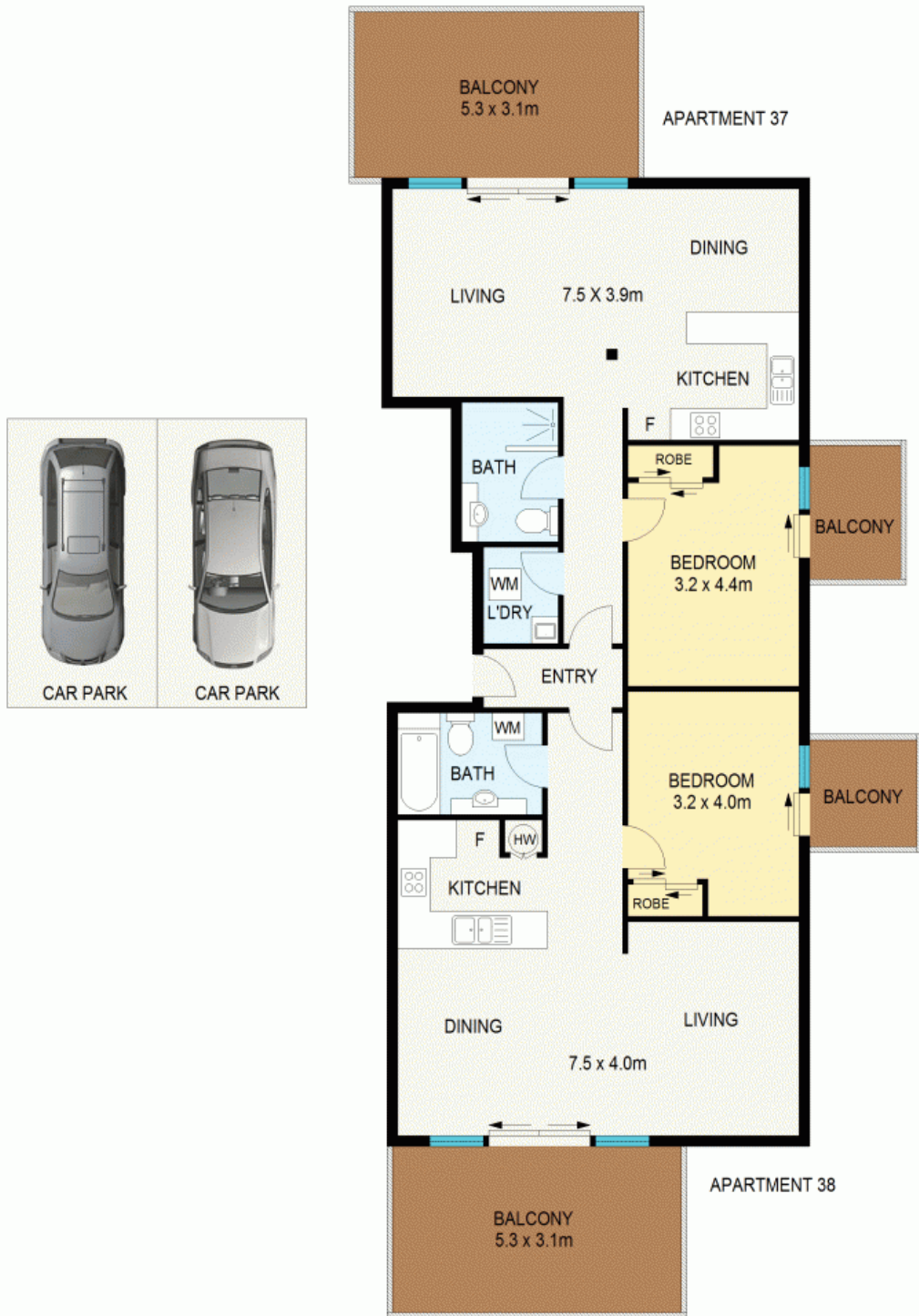

LEVEL 2

APPROX : GROSS INTERNAL AREA :- 138 SQM
APPROX : GROSS EXTERNAL AREA :- 40 SQM



All information contained herein is gathered from sources we believe to be reliable. We cannot however guarantee its accuracy and interested parties should make and rely on their own enquiries



37-38, 100 Leura Mall

Leura

37-38/100-116 Leura Mall

Leura, NSW