

23 Sandbox Road Wentworth Falls, NSW



4



2



2



## NEAR NEW HOME ON A LEVEL BLOCK!

Positioned on a large parcel of level land (1261.03m<sup>2</sup>) in a premier mountains location, this beautifully rendered, 5 year old brick home is flawlessly presented and of the highest quality finish. Low maintenance lawn areas provide lots of scope for garden ideas, and the bright and sunny outlook is framed in every window.

**Council Rates:** \$175.00 p/q

**Water Rates:** \$500.00 p/q

Currently tenanted at \$520 per week until May 21st 2021

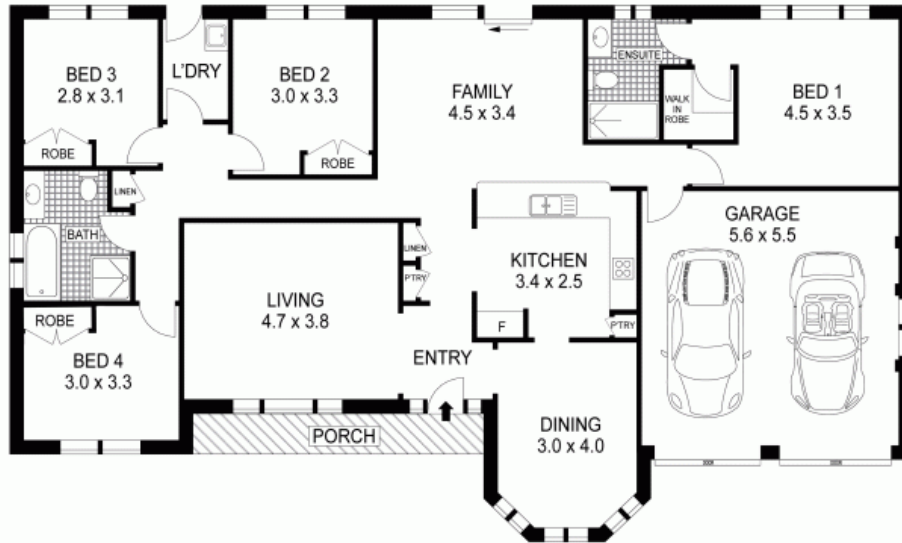

RESIDENCE



0 1 2 3 4 5 SCALE (METERS)

Plans shown are for presentation purposes only and are not part of any legal document or title. They are subject to errors, omissions, inaccuracies and should not be used as a sole and accurate reference. Interested parties should make their own inquiries using independent sources.

23 SANDBOX ROAD

WENTWORTH FALLS