



VIEWS VIEWS VIEWS!!!!

This impeccable grand family residence is a superb expression of modern Australian country architecture and displays perfect site-sensitivity to take full advantage of a stunning outlook. Positioned on a 5659m² parcel of land, it incorporates a full-length, north-facing verandah and fabulous covered deck, with amazing views across bushland and out to distant mountains.

There are four double bedrooms with built-ins, including a luxurious master with walk-in robe and ensuite. The lower level of this expansive home features a fifth bedroom granny flat with ensuite, plus private access to a large paved yard area. An enormous under-house storage space provides further convenience and flexibility, as does the double lock-up garage with a second storage facility. Newly inst

Council Rates: \$524.00 p/q

Water Rates: \$175.00 p/q

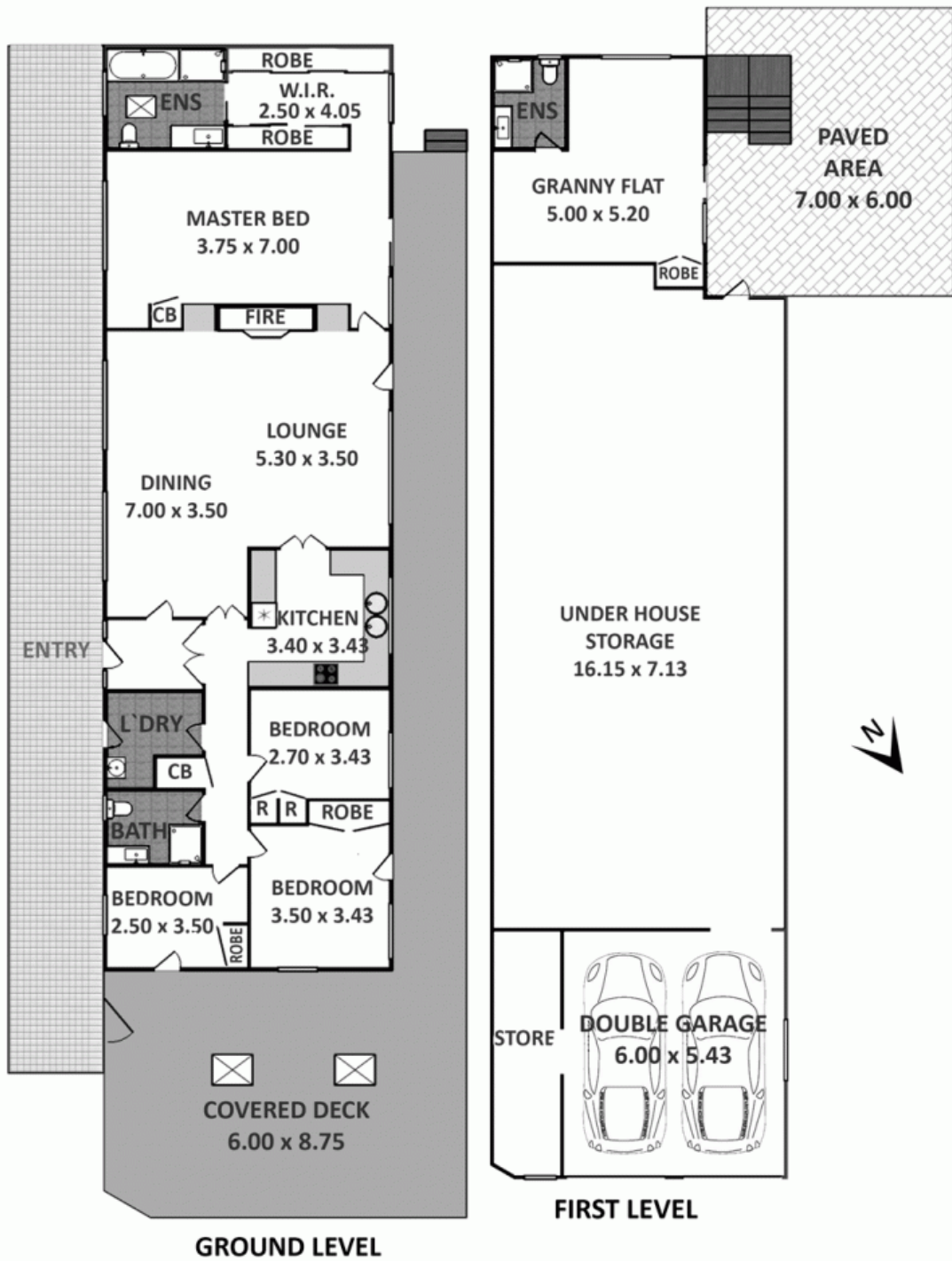

Plans shown are for presentation purposes only and are not part of any legal document or title. They are subject to errors, omissions, inaccuracies and should not be used as a sole and accurate reference. Interested parties should make their own inquiries using independent sources.

12 Lurline Street

WENTWORTH FALLS